

### PRODUCT RANGE OVERVIEW

- MF-HyDrive™ : ALUMINIUM CAPS SERIES
- MF-HyDrive™ SMART: POLYARILAMIDE CAPS SERIES
- MF-HyDrive™ LH LOW/HIGH TEMPERATURE SERIES
- MF-HyDrive™ ATEX ATEX CERTIFIED SERIES
- MF-HyDrive™ BISTABLE : BISTABLE PILOT SERIES

### ENGINEERED DESIGN

Body: aluminum

Seals: PU - NBR - Silicon Viton

Internal parts: aluminum - brass- nickel plated AVP

Caps: 2011 aluminum - black anodized. Polyamide PA6. /polyarylamide IXEF AG (for SMART series)

### KEY FEATURES

**High efficiency in vacuum circuits:** designed to ensure reliable performance in vacuum applications combined with pneumatic actuation.

**Vacuum and compressed air switching:** allows seamless alternation between vacuum and pressure for applications requiring both functions.

**Reliable sealing and switching:** the poppet valve system ensures secure sealing and consistent, dependable operation even under demanding conditions.

**Compact and lightweight design:** ideal for systems where space is limited and vacuum and compressed air must work together efficiently.

**Durable construction:** carefully selected sealing materials guarantee long service life and high resistance under mechanical and operating stress.

### AVAILABLE SIZES

|                               | 1/8" | 1/4" | 3/8" | 1/2" | 3/4" | 1" | 1 1/2" | 2"  |
|-------------------------------|------|------|------|------|------|----|--------|-----|
| Nominal diameter              | 5,5  | 8    | 10   | 15   | 19   | 25 | 39     | 50  |
| Vacuum flow rate at 755 mm HG | 1,5  | 4    | 10   | 20   | 35   | 90 | 180    | 250 |

# MF-HyDrive™

## 3/2 POPPET VALVES VACUUM - AIR

- Range G1/8" ÷ G2"
- Patented conical poppet system and shaped PU membrane
- Version with external pneumatic actuation
- Extreme flexibility suitable for operation with vacuum and compressed air
- Control pressure: 3-10 bar in direct vacuum operations; 6-10 bar in air-vacuum operations
- Robust construction and low weight



### TECHNICAL FEATURES

|                          |  |        |        |                  |        |      |          |      |
|--------------------------|--|--------|--------|------------------|--------|------|----------|------|
| Fluid                    | Filtered compressed air, with or without lubrication - vacuum  |        |        |                  |        |      |          |      |
| Ambient Temp.            | -20 ÷ +50°C  |        |        |                  |        |      |          |      |
| Fluid Temp.              | Max +50°C  |        |        |                  |        |      |          |      |
| Max vacuum               | 755 mmHg   |        |        |                  |        |      |          |      |
| Pilot Pressure           | Max 10 bar   |        |        |                  |        |      |          |      |
| Function                 | 3/2 NC   3/2 NO  |        |        |                  |        |      |          |      |
| Control                  | Pneumatic   Indirect Electric  |        |        |                  |        |      |          |      |
| Return                   | Mechanical and pneumatic spring  |        |        |                  |        |      |          |      |
| Manual control           | Screw, 2 positions   |        |        |                  |        |      |          |      |
| Connection               | G 1/8"   | G 1/4" | G 3/8" | G 1/2"           | G 3/4" | G 1" | G 1 1/2" | G 2" |
| Shape                    |  |        |        |                  |        |      |          |      |
| Ø electric operator (mm) | 10   | 13     |        |                  |        |      |          |      |
| Absorption               | 3,5W (DC) - 5VA (AC)<br>2,5W (DC) - 3,3VA (  |        |        | 11W(DC)-10VA(AC) |        |      |          |      |
| Voltage                  | 12V DC - 24V DC - 24V AC - 110V AC - 220V AC   |        |        |                  |        |      |          |      |
| Mounting position        | Preferably vertical  |        |        |                  |        |      |          |      |
| Materials                | Body: aluminum / Seals: PU - NBR / Internal parts: aluminum - POM - Brass - Nickel Plated AVP<br>Caps: 2011 alloy aluminum - black anodized. |        |        |                  |        |      |          |      |

PRODUCT DATA & CODES

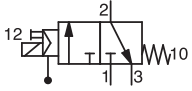
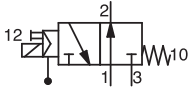
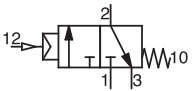
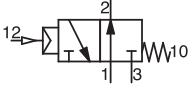
|   | Connection | Control   | Pilot Supply | Ø (mm) | Flow rate (m <sup>3</sup> /h) | Working pressure from/to (bar) | Control pressure from/to (bar) | Time Exc.12/ Dis.10 (ms) | Electric Pilot Ø (mm) | Weight (gr) | Code      |
|---|------------|-----------|--------------|--------|-------------------------------|--------------------------------|--------------------------------|--------------------------|-----------------------|-------------|-----------|
|  <p>3/2 NC<br/>Solenoid/Spring</p>  | G 1/8"     | electric  | external     | 5,5    | 1,5                           | -1,0 --- 6,0                   | 3/6 ---10                      | 15/25                    | 10                    | 155         | -MF-G3001 |
|   | G 1/4"     | electric  | external     | 8      | 4                             | -1,0 --- 6,0                   | 3/6 ---10                      | 18/28                    | 13                    | 480         | -MF-G3009 |
|   | G 3/8"     | electric  | external     | 10     | 10                            | -1,0 --- 6,0                   | 3/6 ---10                      | 18/28                    | 13                    | 465         | -MF-G3011 |
|   | G 1/2"     | electric  | external     | 15     | 20                            | -1,0 --- 6,0                   | 3/6 ---10                      | 20/40                    | 13                    | 805         | -MF-G3020 |
|   | G 3/4"     | electric  | external     | 19     | 35                            | -1,0 --- 6,0                   | 3/6 ---10                      | 20/40                    | 13                    | 775         | -MF-G3040 |
|   | G 1"       | electric  | external     | 25     | 90                            | -1,0 --- 6,0                   | 3/6 ---10                      | 20/45                    | 13                    | 1160        | -MF-G3050 |
|   | G 1 1/2"   | electric  | external     | 39     | 180                           | -1,0 --- 6,0                   | 3/6 ---10                      | 60/40                    | 13                    | 3350        | -MF-G3060 |
|   | G 2"       | electric  | external     | 50     | 250                           | -1,0 --- 6,0                   | 3/6 ---10                      | 80/50                    | 13                    | 8700        | -MF-G3068 |
|  <p>3/2 NO<br/>Solenoid/Spring</p> | G 1/8"     | electric  | external     | 5,5    | 1,5                           | -1,0 --- 6,0                   | 3/6 ---10                      | 15/25                    | 10                    | 155         | -MF-G3002 |
|   | G 1/4"     | electric  | external     | 8      | 4                             | -1,0 --- 6,0                   | 3/6 ---10                      | 18/28                    | 13                    | 480         | -MF-G3010 |
|   | G 3/8"     | electric  | external     | 10     | 10                            | -1,0 --- 6,0                   | 3/6 ---10                      | 18/28                    | 13                    | 465         | -MF-G3012 |
|   | G 1/2"     | electric  | external     | 15     | 20                            | -1,0 --- 6,0                   | 3/6 ---10                      | 20/40                    | 13                    | 805         | -MF-G3021 |
|   | G 3/4"     | electric  | external     | 19     | 35                            | -1,0 --- 6,0                   | 3/6 ---10                      | 20/40                    | 13                    | 775         | -MF-G3041 |
|   | G 1"       | electric  | external     | 25     | 90                            | -1,0 --- 6,0                   | 3/6 ---10                      | 20/45                    | 13                    | 1160        | -MF-G3051 |
|   | G 1 1/2"   | electric  | external     | 39     | 180                           | -1,0 --- 6,0                   | 3/6 ---10                      | 60/40                    | 13                    | 3350        | -MF-G3061 |
|   | G 2"       | electric  | external     | 50     | 250                           | -1,0 --- 6,0                   | 3/6 ---10                      | 80/50                    | 13                    | 8700        | -MF-G3069 |
|  <p>3/2 NC<br/>Air/Spring</p>     | G 1/8"     | pneumatic | ---          | 5,5    | 1,5                           | -1,0 --- 6,0                   | 3/6 ---10                      | 04/08                    |                       | 125         | -MF-G3071 |
|   | G 1/4"     | pneumatic | ---          | 8      | 4                             | -1,0 --- 6,0                   | 3/6 ---10                      | 05/10                    |                       | 360         | -MF-G3073 |
|   | G 3/8"     | pneumatic | ---          | 10     | 10                            | -1,0 --- 6,0                   | 3/6 ---10                      | 08/10                    |                       | 345         | -MF-G3075 |
|   | G 1/2"     | pneumatic | ---          | 15     | 20                            | -1,0 --- 6,0                   | 3/6 ---10                      | 08/15                    |                       | 705         | -MF-G3081 |
|   | G 3/4"     | pneumatic | ---          | 19     | 35                            | -1,0 --- 6,0                   | 3/6 ---10                      | 10/15                    |                       | 675         | -MF-G3091 |
|   | G 1"       | pneumatic | ---          | 25     | 90                            | -1,0 --- 6,0                   | 3/6 ---10                      | 10/17                    |                       | 1060        | -MF-G3100 |
|   | G 1 1/2"   | pneumatic | ---          | 39     | 180                           | -1,0 --- 6,0                   | 3/6 ---10                      | 65/30                    |                       | 3235        | -MF-G3110 |
|   | G 2"       | pneumatic | ---          | 50     | 250                           | -1,0 --- 6,0                   | 3/6 ---10                      | 80/40                    |                       | 8585        | -MF-G3120 |
|  <p>3/2 NO<br/>Air/Spring</p>     | G 1/8"     | pneumatic | ---          | 5,5    | 1,5                           | -1,0 --- 6,0                   | 3/6 ---10                      | 04/08                    |                       | 125         | -MF-G3072 |
|   | G 1/4"     | pneumatic | ---          | 8      | 4                             | -1,0 --- 6,0                   | 3/6 ---10                      | 05/10                    |                       | 360         | -MF-G3074 |
|   | G 3/8"     | pneumatic | ---          | 10     | 10                            | -1,0 --- 6,0                   | 3/6 ---10                      | 08/10                    |                       | 345         | -MF-G3076 |
|   | G 1/2"     | pneumatic | ---          | 15     | 20                            | -1,0 --- 6,0                   | 3/6 ---10                      | 08/15                    |                       | 705         | -MF-G3082 |
|   | G 3/4"     | pneumatic | ---          | 19     | 35                            | -1,0 --- 6,0                   | 3/6 ---10                      | 10/15                    |                       | 675         | -MF-G3092 |
|   | G 1"       | pneumatic | ---          | 25     | 90                            | -1,0 --- 6,0                   | 3/6 ---10                      | 10/17                    |                       | 1060        | -MF-G3101 |
|   | G 1 1/2"   | pneumatic | ---          | 39     | 180                           | -1,0 --- 6,0                   | 3/6 ---10                      | 65/30                    |                       | 3235        | -MF-G3111 |
|   | G 2"       | pneumatic | ---          | 50     | 250                           | -1,0 --- 6,0                   | 3/6 ---10                      | 80/40                    |                       | 8585        | -MF-G3121 |

\* Control pressure from/to (bar) : 3,0 --- 10 ( Vacuum-Vacuum operation) | 6,0 --- 10 (Vacuum - Air operation)

## ACCESSORIES & SPARE PARTS

> Function 100% EDP > Voltage ± 10% > Frequency ± 5%

### COILS

|  | Coil width (mm) | Operator Ø (mm) | Voltage | Power  | Code     |
|--|-----------------|-----------------|---------|--------|----------|
|  | 22              | 10              | 12 VDC  | 3,5 W  | -MF-0050 |
|  | 22              | 10              | 24 VDC  | 3,5 W  | -MF-0051 |
|  | 22              | 10              | 24 VDA  | 5 VA   | -MF-0106 |
|  | 22              | 10              | 110 VDA | 5 VA   | -MF-0108 |
|  | 22              | 10              | 220 VDA | 5 VA   | -MF-0124 |
|  | 30              | 10              | 12 VDC  | 2,5 W  | -MF-0301 |
|  | 30              | 10              | 24 VDC  | 2,5 W  | -MF-0302 |
|  | 30              | 10              | 24 VDA  | 3,3 VA | -MF-0307 |
|  | 30              | 10              | 110 VDA | 3,3 VA | -MF-0309 |
|  | 30              | 10              | 220 VDA | 3,3 VA | -MF-0310 |
|  | 30              | 13              | 12 VDC  | 11 W   | -MF-0501 |
|  | 30              | 13              | 24 VDC  | 11 W   | -MF-0502 |
|  | 30              | 13              | 24 VDA  | 10 VA  | -MF-0507 |
|  | 30              | 13              | 110 VDA | 10 VA  | -MF-0509 |
|  | 30              | 13              | 220 VDA | 10 VA  | -MF-0510 |

> IP65 > PG9

### CONNECTORS

|                        | Coil width (mm) | Voltage                  | Led-Vdr | Code      |
|------------------------|-----------------|--------------------------|---------|-----------|
| <b>DIN 43650-B</b><br> | 22              | 24V - 48V - 110 V- 220 V | -       | -AM-5110  |
|                        | 22              | 24 volt                  | ✓       | -AM-5112L |
|                        | 22              | 110 volt                 | ✓       | -AM-5113L |
|                        | 22              | 220 volt                 | ✓       | -AM-5114L |
| <b>DIN 43650-A</b><br> | 30              | 24V - 48V - 110 V- 220 V | -       | -AM-5111  |
|                        | 30              | 24 volt                  | ✓       | -AM-5115L |
|                        | 30              | 110 volt                 | ✓       | -AM-5116L |
|                        | 30              | 220 volt                 | ✓       | -AM-5117L |

### SERVICE KIT

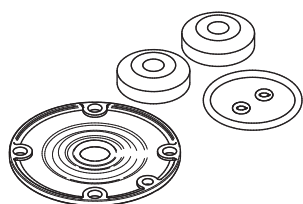

| Description  | Connection      | Code      |
|--|-----------------|-----------|
| Buffers, lip seals, o-rings                              | G 1/8"          | -MF-F9605 |
| Buffers, lip seals, o-rings                              | G 1/4" - G 3/8" | -MF-F9610 |
| Membrane, buffers, o-rings                               | G 1/2" - G 3/4" | -MF-F9615 |
| Membrane, buffers, o-rings                               | G 1"            | -MF-F9620 |
| Membrane, buffers, o-rings, quick-discharge membrane     | G 1 1/2"        | -MF-F9625 |
| Buffers, lip seals, o-rings, quick exhaust membrane G 2" | G 2"            | -MF-F9630 |



## MF-HyDrive™

ALL DATA SHEET AVAILABLE AT:  
[MECFLUID2.COM](http://MECFLUID2.COM)

SCAN THIS QR CODE



# MF-HyDrive™ SMART

## 3/2 POPPET VALVES

### VACUUM - AIR

### SMART

- Range G1/8" ÷ G1"
- The **SMART** version of the MF-HyDrive™ valves patented by Mec Fluid 2
- Patented conical poppet system and shaped PU membrane. External pneumatic actuation
- Extreme flexibility suitable for operation with vacuum and compressed air
- Control pressure: 3-10 bar in direct vacuum operations; 6-10 bar in air-vacuum operations



## TECHNICAL FEATURES

|                          |  |        |        |                  |        |      |  |
|--------------------------|--|--------|--------|------------------|--------|------|--|
| Fluid                    | Filtered compressed air, with or without lubrication - vacuum  |        |        |                  |        |      |  |
| Ambient Temp.            | -20 ÷ +50°C  |        |        |                  |        |      |  |
| Fluid Temp.              | Max +50°C  |        |        |                  |        |      |  |
| Max vacuum               | 755 mmHg   |        |        |                  |        |      |  |
| Pressure                 | Max 10 bar   |        |        |                  |        |      |  |
| Function                 | 3/2 NC   3/2 NO  |        |        |                  |        |      |  |
| Control                  | Pneumatic   Indirect Electric  |        |        |                  |        |      |  |
| Return                   | Mechanical and pneumatic spring  |        |        |                  |        |      |  |
| Manual control           | Screw, 2 positions   |        |        |                  |        |      |  |
| Connection               | G 1/8"   | G 1/4" | G 3/8" | G 1/2"           | G 3/4" | G 1" |  |
| Shape                    |  |        |        |                  |        |      |  |
| Ø electric operator (mm) | 10   |        |        | 13               |        |      |  |
| Absorption               | 3,5W (DC) - 5VA (AC)<br>2,5W (DC) - 3,3VA (AC)   |        |        | 11W(DC)-10VA{AC} |        |      |  |
| Voltage                  | 12V DC - 24V DC - 24V AC - 110V AC - 220V AC   |        |        |                  |        |      |  |
| Mounting position        | Preferably vertical  |        |        |                  |        |      |  |
| Materials                | Body: aluminum / Seals: PU - NBR / Internal parts: aluminum - POM - Brass - Nickel Plated AVP<br>Caps: sizes from G 1/8" to G 3/8" standard in polyamide PA6. Sizes G 1/2" G 3/4", G 1" in polyarylamide IXEF AG |        |        |                  |        |      |  |

PRODUCT DATA & CODES

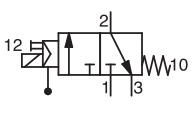
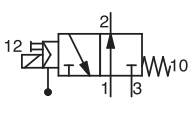
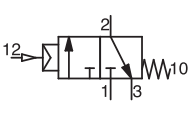
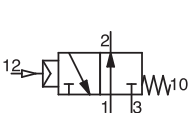
|   | Connection | Control   | Pilot Supply | Ø (mm) | Flow rate (mq/h) | Working pressure (P1) from/to (bar) | Control pressure from/to (bar) | Time Exc.12/ Dis.10 (ms) | Electric Pilot Ø (mm) | Weight (gr) | Code       |
|---|------------|-----------|--------------|--------|------------------|-------------------------------------|--------------------------------|--------------------------|-----------------------|-------------|------------|
|  <p>3/2 NC Solenoid/Spring</p>  | G 1/8"     | electric  | external     | 5,5    | 1,5              | -1,0 --- 6,0                        | 3/6 ---10                      | 15/25                    | 10                    | 140         | -MF-G3001S |
|   | G 1/4"     | electric  | external     | 8      | 4                | -1,0 --- 6,0                        | 3/6 ---10                      | 18/28                    | 13                    | 420         | -MF-G3009S |
|   | G 3/8"     | electric  | external     | 10     | 10               | -1,0 --- 6,0                        | 3/6 ---10                      | 18/28                    | 13                    | 405         | -MF-G3011S |
|   | G 1/2"     | electric  | external     | 15     | 20               | -1,0 --- 6,0                        | 3/6 ---10                      | 20/40                    | 13                    | 680         | -MF-G3020S |
|   | G 3/4"     | electric  | external     | 19     | 35               | -1,0 --- 6,0                        | 3/6 ---10                      | 20/40                    | 13                    | 650         | -MF-G3040S |
|   | G 1"       | electric  | external     | 25     | 90               | -1,0 --- 6,0                        | 3/6 ---10                      | 20/45                    | 13                    | 1000        | -MF-G3050S |
|  <p>3/2 NO Solenoid/Spring</p> | G 1/8"     | electric  | external     | 5,5    | 1,5              | -1,0 --- 6,0                        | 3/6 ---10                      | 15/25                    | 10                    | 140         | -MF-G3002S |
|   | G 1/4"     | electric  | external     | 8      | 4                | -1,0 --- 6,0                        | 3/6 ---10                      | 18/28                    | 13                    | 420         | -MF-G3010S |
|   | G 3/8"     | electric  | external     | 10     | 10               | -1,0 --- 6,0                        | 3/6 ---10                      | 18/28                    | 13                    | 405         | -MF-G3012S |
|   | G 1/2"     | electric  | external     | 15     | 20               | -1,0 --- 6,0                        | 3/6 ---10                      | 20/40                    | 13                    | 680         | -MF-G3021S |
|   | G 3/4"     | electric  | external     | 19     | 35               | -1,0 --- 6,0                        | 3/6 ---10                      | 20/40                    | 13                    | 650         | -MF-G3041S |
|   | G 1"       | electric  | external     | 25     | 90               | -1,0 --- 6,0                        | 3/6 ---10                      | 20/45                    | 13                    | 1000        | -MF-G3051S |
|  <p>3/2 NC Air/Spring</p>     | G 1/8"     | pneumatic | ---          | 5,5    | 1,5              | -1,0 --- 6,0                        | 3/6 ---10                      | 04/08                    |                       | 95          | -MF-G3071S |
|   | G 1/4"     | pneumatic | ---          | 8      | 4                | -1,0 --- 6,0                        | 3/6 ---10                      | 05/10                    |                       | 295         | -MF-G3073S |
|   | G 3/8"     | pneumatic | ---          | 10     | 10               | -1,0 --- 6,0                        | 3/6 ---10                      | 08/10                    |                       | 285         | -MF-G3075S |
|   | G 1/2"     | pneumatic | ---          | 15     | 20               | -1,0 --- 6,0                        | 3/6 ---10                      | 08/15                    |                       | 580         | -MF-G3081S |
|   | G 3/4"     | pneumatic | ---          | 19     | 35               | -1,0 --- 6,0                        | 3/6 ---10                      | 10/15                    |                       | 530         | -MF-G3091S |
|   | G 1"       | pneumatic | ---          | 25     | 90               | -1,0 --- 6,0                        | 3/6 ---10                      | 10/17                    |                       | 900         | -MF-G3100S |
|  <p>3/2 NO Air/Spring</p>     | G 1/8"     | pneumatic | ---          | 5,5    | 1,5              | -1,0 --- 6,0                        | 3/6 ---10                      | 04/08                    |                       | 95          | -MF-G3072S |
|   | G 1/4"     | pneumatic | ---          | 8      | 4                | -1,0 --- 6,0                        | 3/6 ---10                      | 05/10                    |                       | 295         | -MF-G3074S |
|   | G 3/8"     | pneumatic | ---          | 10     | 10               | -1,0 --- 6,0                        | 3/6 ---10                      | 08/10                    |                       | 285         | -MF-G3076S |
|   | G 1/2"     | pneumatic | ---          | 15     | 20               | -1,0 --- 6,0                        | 3/6 ---10                      | 08/15                    |                       | 580         | -MF-G3082S |
|   | G 3/4"     | pneumatic | ---          | 19     | 35               | -1,0 --- 6,0                        | 3/6 ---10                      | 10/15                    |                       | 530         | -MF-G3092S |
|   | G 1"       | pneumatic | ---          | 25     | 90               | -1,0 --- 6,0                        | 3/6 ---10                      | 10/17                    |                       | 900         | -MF-G3101S |

\* Control pressure from/to (bar) : 3,0 --- 10 ( Vacuum-Vacuum operation) | 6,0 --- 10 (Vacuum - Air operation)



## ACCESSORIES & SPARE PARTS

► Function 100% EDP ► Voltage ± 10% ► Frequency ± 5%

### COILS

|  | Coil width (mm) | Operator Ø (mm) | Voltage | Power  | Code     |
|--|-----------------|-----------------|---------|--------|----------|
|  | 22              | 10              | 12 VDC  | 3,5 W  | -MF-0050 |
|  | 22              | 10              | 24 VDC  | 3,5 W  | -MF-0051 |
|  | 22              | 10              | 24 VAC  | 5 VA   | -MF-0106 |
|  | 22              | 10              | 110 VAC | 5 VA   | -MF-0108 |
|  | 22              | 10              | 220 VAC | 5 VA   | -MF-0124 |
|  | 30              | 10              | 12 VDC  | 2,5 W  | -MF-0301 |
|  | 30              | 10              | 24 VDC  | 2,5 W  | -MF-0302 |
|  | 30              | 10              | 24 VAC  | 3,3 VA | -MF-0307 |
|  | 30              | 10              | 110 VAC | 3,3 VA | -MF-0309 |
|  | 30              | 10              | 220 VAC | 3,3 VA | -MF-0310 |
|  | 30              | 13              | 12 VDC  | 11 W   | -MF-0501 |
|  | 30              | 13              | 24 VDC  | 11 W   | -MF-0502 |
|  | 30              | 13              | 24 VAC  | 10 VA  | -MF-0507 |
|  | 30              | 13              | 110 VAC | 10 VA  | -MF-0509 |
|  | 30              | 13              | 220 VAC | 10 VA  | -MF-0510 |

► IP65 ► PG9

### CONNECTORS

|                        | Coil width (mm) | Voltage                  | Led-Vdr | Code      |
|------------------------|-----------------|--------------------------|---------|-----------|
| <b>DIN 43650-B</b><br> | 22              | 24V - 48V - 110 V- 220 V | -       | -AM-5110  |
|                        | 22              | 24 volt                  | ✓       | -AM-5112L |
|                        | 22              | 110 volt                 | ✓       | -AM-5113L |
|                        | 22              | 220 volt                 | ✓       | -AM-5114L |
| <b>DIN 43650-A</b><br> | 30              | 24V - 48V - 110 V- 220 V | -       | -AM-5111  |
|                        | 30              | 24 volt                  | ✓       | -AM-5115L |
|                        | 30              | 110 volt                 | ✓       | -AM-5116L |
|                        | 30              | 220 volt                 | ✓       | -AM-5117L |

### SERVICE KIT

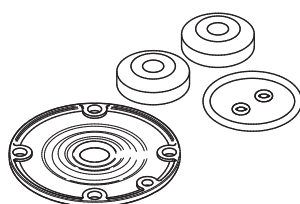

| Description  | Connection      | Code      |
|--|-----------------|-----------|
| Buffers, lip seals, o-rings                              | G 1/8"          | -MF-F9605 |
| Buffers, lip seals, o-rings                              | G 1/4" - G 3/8" | -MF-F9610 |
| Membrane, buffers, o-rings                               | G 1/2" - G 3/4" | -MF-F9615 |
| Membrane, buffers, o-rings                               | G 1"            | -MF-F9620 |
| Membrane, buffers, o-rings, quick-discharge membrane     | G 1 1/2"        | -MF-F9625 |
| Buffers, lip seals, o-rings, quick exhaust membrane G 2" | G 2"            | -MF-F9630 |



## MF-HyDrive™ 3/2 POPPET VALVES

ALL DATA SHEET AVAILABLE  
[MECFLUID2.COM](http://MECFLUID2.COM)

SCAN THIS QR CODE



# MF-HyDrive™ LH

3/2 POPPET VALVES

**VACUUM - AIR**

**LOW/HIGH TEMPERATURE**

- Range G1/4" ÷ G2"
- The **Low/High temp.** version of MF-HyDrive™
- Extreme flexibility suitable for operation with vacuum and compressed air
- Robust construction and low weight
- Control pressure: 3-10 bar in direct vacuum operations; 6-10 bar in air-vacuum operations

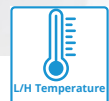

## TECHNICAL FEATURES

|                          |  |        |        |                  |      |          |      |
|--------------------------|--|--------|--------|------------------|------|----------|------|
| Fluid                    | Filtered compressed air, with or without lubrication - vacuum  |        |        |                  |      |          |      |
| Ambient Temp.            | -40°C ÷ +50°C (L) / -10°C ÷ +150°C (H)   |        |        |                  |      |          |      |
| Fluid Temp.              | Max +50°C  |        |        |                  |      |          |      |
| Max vacuum               | 755 mmHg   |        |        |                  |      |          |      |
| Pressure                 | Max 10 bar   |        |        |                  |      |          |      |
| Function                 | 3/2 NC   3/2 NO  |        |        |                  |      |          |      |
| Control                  | Pneumatic   Indirect Electric  |        |        |                  |      |          |      |
| Return                   | Mechanical and pneumatic spring  |        |        |                  |      |          |      |
| Manual control           |  |        |        |                  |      |          |      |
| Connection               | G 1/4"   | G 3/8" | G 1/2" | G 3/4"           | G 1" | G 1 1/2" | G 2" |
| Shape                    |  |        |        |                  |      |          |      |
| Ø electric operator (mm) | 13   |        |        |                  |      |          |      |
| Absorption               | 3,5W (DC) - 5VA (AC)<br>2,5W (DC) - 3,3VA (AC)   |        |        | 11W(DC)-10VA(AC) |      |          |      |
| Voltage                  | 12V DC – 24V DC – 24V AC – 110V AC – 220V AC   |        |        |                  |      |          |      |
| Mounting position        | Preferably vertical  |        |        |                  |      |          |      |
| Materials                | Body: aluminum / Seals: Viton (H version)- NBR - Silicon (L version) / Internal parts: aluminum - Brass<br>Caps: aluminium |        |        |                  |      |          |      |

PRODUCT DATA & CODES

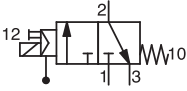
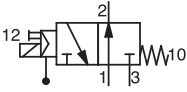
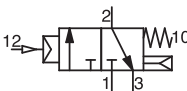
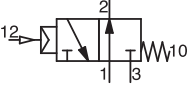
| Connection  | Control  | Ø (mm) | Flow rate (mq/h) | Pilot Supply | Working pressure (P1) from/to (bar) | Control pressure from/to (bar) | Time Exc.12/ Dis.10 (ms) | Electric Pilot Ø (mm) | Weight (gr) LOW/HIGH | Code LOW temp. | Code HIGH temp. |
|---|----------|--------|------------------|--------------|-------------------------------------|--------------------------------|--------------------------|-----------------------|----------------------|----------------|-----------------|
|  <p>3/2 NC Solenoid/Spring</p>  | G 1/4"   | 8      | 4                | external     | -1,0 --- 6,0                        | 6,0 ---10                      | 18/28                    | 13                    | 380/400              | -MF-G3009L     | -MF-G3009H      |
|   | G 3/8"   | 10     | 10               | external     | -1,0 --- 6,0                        | 6,0 ---10                      | 18/28                    | 13                    | 365/385              | -MF-G3011L     | -MF-G3011H      |
|   | G 1/2"   | 15     | 20               | external     | -1,0 --- 6,0                        | 6,0 ---10                      | 20/40                    | 13                    | 965/985              | -MF-G3020L     | -MF-G3020H      |
|   | G 3/4"   | 19     | 35               | external     | -1,0 --- 6,0                        | 6,0 ---10                      | 20/40                    | 13                    | 925/945              | -MF-G3040L     | -MF-G3040H      |
|   | G 1"     | 25     | 90               | external     | -1,0 --- 6,0                        | 6,0 ---10                      | 20/45                    | 13                    | 1465/1485            | -MF-G3050L     | -MF-G3050H      |
|   | G 1 1/2" | 39     | 180              | external     | -1,0 --- 6,0                        | 6,0 ---10                      | 60/40                    | 13                    | 4330/4350            | -MF-G3060L     | -MF-G3060H      |
|   | G 2"     | 50     | 250              | external     | -1,0 --- 6,0                        | 6,0 ---10                      | 80/50                    | 13                    | 8880/8900            | -MF-G3068L     | -MF-G3068H      |
|  <p>3/2 NO Solenoid/Spring</p> | G 1/4"   | 8      | 4                | external     | -1,0 --- 6,0                        | 6,0 ---10                      | 18/28                    | 13                    | 380/400              | -MF-G3010L     | -MF-G3010H      |
|   | G 3/8"   | 10     | 10               | external     | -1,0 --- 6,0                        | 6,0 ---10                      | 18/28                    | 13                    | 365/385              | -MF-G3012L     | -MF-G3012H      |
|   | G 1/2"   | 15     | 20               | external     | -1,0 --- 6,0                        | 6,0 ---10                      | 20/40                    | 13                    | 965/985              | -MF-G3021L     | -MF-G3021H      |
|   | G 3/4"   | 19     | 35               | external     | -1,0 --- 6,0                        | 6,0 ---10                      | 20/40                    | 13                    | 925/945              | -MF-G3041L     | -MF-G3041H      |
|   | G 1"     | 25     | 90               | external     | -1,0 --- 6,0                        | 6,0 ---10                      | 20/45                    | 13                    | 1465/1485            | -MF-G3051L     | -MF-G3051H      |
|   | G 1 1/2" | 39     | 180              | external     | -1,0 --- 6,0                        | 6,0 ---10                      | 60/40                    | 13                    | 4330/4350            | -MF-G3061L     | -MF-G3061H      |
|   | G 2"     | 50     | 250              | external     | -1,0 --- 6,0                        | 6,0 ---10                      | 80/50                    | 13                    | 8880/8900            | -MF-G3069L     | -MF-G3069H      |
|  <p>3/2 NC Air/Spring</p>     | G 1/4"   | 8      | 4                | ---          | -1,0 --- 6,0                        | 6,0 ---10                      | 5/10                     |                       | 300/300              | -MF-G3073L     | -MF-G3073H      |
|   | G 3/8"   | 10     | 10               | ---          | -1,0 --- 6,0                        | 6,0 ---10                      | 8/10                     |                       | 285/285              | -MF-G3075L     | -MF-G3075H      |
|   | G 1/2"   | 15     | 20               | ---          | -1,0 --- 6,0                        | 6,0 ---10                      | 8/15                     |                       | 885/885              | -MF-G3081L     | -MF-G3081H      |
|   | G 3/4"   | 19     | 35               | ---          | -1,0 --- 6,0                        | 6,0 ---10                      | 10/15                    |                       | 845/845              | -MF-G3091L     | -MF-G3091H      |
|   | G 1"     | 25     | 90               | ---          | -1,0 --- 6,0                        | 6,0 ---10                      | 10/17                    |                       | 1385/1385            | -MF-G3100L     | -MF-G3100H      |
|   | G 1 1/2" | 39     | 180              | ---          | -1,0 --- 6,0                        | 6,0 ---10                      | 65/30                    |                       | 4150/4150            | -MF-G3110L     | -MF-G3110H      |
|   | G 2"     | 50     | 250              | ---          | -1,0 --- 6,0                        | 6,0 ---10                      | 80/40                    |                       | 8750/8750            | -MF-G3120L     | -MF-G3120H      |
|  <p>3/2 NO Air/Spring</p>     | G 1/4"   | 8      | 4                | ---          | -1,0 --- 6,0                        | 6,0 ---10                      | 18/28                    |                       | 300/300              | -MF-G3074L     | -MF-G3074H      |
|   | G 3/8"   | 10     | 10               | ---          | -1,0 --- 6,0                        | 6,0 ---10                      | 18/28                    |                       | 285/285              | -MF-G3076L     | -MF-G3076H      |
|   | G 1/2"   | 15     | 20               | ---          | -1,0 --- 6,0                        | 6,0 ---10                      | 20/40                    |                       | 885/885              | -MF-G3082L     | -MF-G3082H      |
|   | G 3/4"   | 19     | 35               | ---          | -1,0 --- 6,0                        | 6,0 ---10                      | 20/40                    |                       | 845/845              | -MF-G3092L     | -MF-G3092H      |
|   | G 1"     | 25     | 90               | ---          | -1,0 --- 6,0                        | 6,0 ---10                      | 20/45                    |                       | 1385/1385            | -MF-G3101L     | -MF-G3101H      |
|   | G 1 1/2" | 39     | 180              | ---          | -1,0 --- 6,0                        | 6,0 ---10                      | 60/40                    |                       | 4150/4150            | -MF-G3111L     | -MF-G3111H      |
|   | G 2"     | 50     | 250              | ---          | -1,0 --- 6,0                        | 6,0 ---10                      | 80/50                    |                       | 8750/8750            | -MF-G3121L     | -MF-G3121H      |

\* Control pressure from/to (bar) : 3,0 --- 10 ( Vacuum-Vacuum operation) | 6,0 --- 10 (Vacuum - Air operation)

## ACCESSORIES & SPARE PARTS

### COILS

UPON REQUEST TO the Mec Fluid Technical Department

### CONNECTORS

UPON REQUEST TO the Mec Fluid Technical Department

### SERVICE KIT

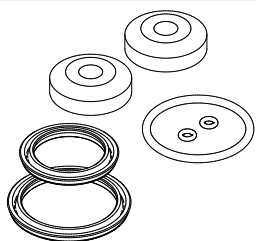

| Description  | Connection      | Code         |
|--|-----------------|--------------|
| Buffers, lip seals, o-rings                              | G 1/8"          | -MF-F9605L/H |
| Buffers, lip seals, o-rings                              | G 1/4" - G 3/8" | -MF-F9610L/H |
| Membrane, pads, o-rings                                  | G 1/2" - G 3/4" | -MF-F9615L/H |
| Membrane, pads, o-rings                                  | G 1"            | -MF-F9620L/H |
| Membrane, pads, o-rings, quick-discharge membrane        | G 1 1/2"        | -MF-F9625L/H |
| Buffers, lip seals, o-rings, quick exhaust membrane G 2" | G 2"            | -MF-F9630L/H |



## MF-HyDrive™ 3/2 POPPET VALVES

ALL DATA SHEET AVAILABLE  
[MECFLUID2.COM](http://MECFLUID2.COM)

SCAN THIS QR CODE



# MF-HyDrive™ ATEX

## 3/2 POPPET VALVES

### VACUUM - AIR

#### ATEX CERTIFIED

- Range G 1/8" + G 2"
- Body and caps in aluminium
- Also available with external pilot control
- Conformity with EU Directive 2014/34 **CE Ex**  
**ELECTRIC CONTROL** II 3G Ex h IIC T3 Gg  
 II 3D Ex h IIIC T200°C Dc  
**PNEUMATIC CONTROL** II 3G Ex h IIC T6 Gg  
 II 3D Ex h IIIC T85°C Dc
- Control pressure: 3-10 bar in direct vacuum operations;  
 6-10 bar in air-vacuum operations



## TECHNICAL FEATURES

|                          |  |        |                                    |        |        |      |          |      |
|--------------------------|--|--------|------------------------------------|--------|--------|------|----------|------|
| Fluid                    | Filtered compressed air, with or without lubrication - vacuum  |        |                                    |        |        |      |          |      |
| Ambient Temp.            | -20 ÷ +50°C  |        |                                    |        |        |      |          |      |
| Fluid Temp.              | Max +50°C  |        |                                    |        |        |      |          |      |
| Max vacuum               | 755 mmHg   |        |                                    |        |        |      |          |      |
| Pressure                 | Max 10 bar   |        |                                    |        |        |      |          |      |
| Function                 | 3/2 NC   3/2 NO  |        |                                    |        |        |      |          |      |
| Control                  | Pneumatic   Indirect Electric  |        |                                    |        |        |      |          |      |
| Return                   | Mechanical and pneumatic spring  |        |                                    |        |        |      |          |      |
| Connection               | G 1/8"   | G 1/4" | G 3/8"                             | G 1/2" | G 3/4" | G 1" | G 1 1/2" | G 2" |
| Shape                    |  |        |                                    |        |        |      |          |      |
| Ø electric operator (mm) | 10   | 13     |                                    |        |        |      |          |      |
| Absorption               | 8VA (AC) - 7W (DC)<br>10VA (AC) 11VA (AC)  |        | 11W(DC)-15VA(AC)-17VA(AC)-25VA(AC) |        |        |      |          |      |
| Voltage                  | 24VDC - 24VAC - 110VAC - 220VAC  |        |                                    |        |        |      |          |      |
| Mounting position        | Preferably vertical  |        |                                    |        |        |      |          |      |
| Materials                | Body: aluminum / Seals: PU - NBR / Internal parts: aluminum - POM - Brass - Nickel Plated<br>Caps: 2011 alloy aluminum - black anodized. |        |                                    |        |        |      |          |      |

PRODUCT DATA & CODES

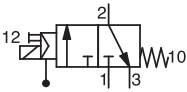
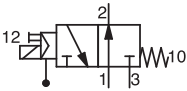
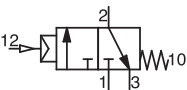
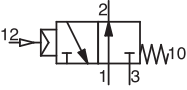
|   | Connection | Control   | Pilot Supply | Ø (mm) | Flow rate (mq/h) | Working pressure (P1) from/to (bar) | Control pressure from/to (bar) | Time Exc.12/ Dis.10 (ms) | Electric Pilot Ø (mm) | Weight (gr) | Code       |
|---|------------|-----------|--------------|--------|------------------|-------------------------------------|--------------------------------|--------------------------|-----------------------|-------------|------------|
|  <p>3/2 NC Solenoid/Spring</p>  | G 1/8"     | electric  | external     | 5,5    | 1,5              | -1,0 --- 6,0                        | 3/6 ---10                      | 15/25                    | 10                    | 145         | -MF-G3001X |
|   | G 1/4"     | electric  | external     | 8      | 4                | -1,0 --- 6,0                        | 3/6 ---10                      | 18/28                    | 13                    | 470         | -MF-G3009X |
|   | G 3/8"     | electric  | external     | 10     | 10               | -1,0 --- 6,0                        | 3/6 ---10                      | 18/28                    | 13                    | 455         | -MF-G3011X |
|   | G 1/2"     | electric  | external     | 15     | 20               | -1,0 --- 6,0                        | 3/6 ---10                      | 20/40                    | 13                    | 795         | -MF-G3020X |
|   | G 3/4"     | electric  | external     | 19     | 35               | -1,0 --- 6,0                        | 3/6 ---10                      | 20/40                    | 13                    | 765         | -MF-G3040X |
|   | G 1"       | electric  | external     | 25     | 90               | -1,0 --- 6,0                        | 3/6 ---10                      | 20/45                    | 13                    | 1150        | -MF-G3050X |
|   | G 1 1/2"   | electric  | external     | 39     | 180              | -1,0 --- 6,0                        | 3/6 ---10                      | 60/40                    | 13                    | 3340        | -MF-G3060X |
|   | G 2"       | electric  | external     | 50     | 250              | -1,0 --- 6,0                        | 3/6 ---10                      | 80/50                    | 13                    | 8690        | -MF-G3068X |
|  <p>3/2 NO Solenoid/Spring</p> | G 1/8"     | electric  | external     | 5,5    | 1,5              | -1,0 --- 6,0                        | 3/6 ---10                      | 15/25                    | 10                    | 145         | -MF-G3002X |
|   | G 1/4"     | electric  | external     | 8      | 4                | -1,0 --- 6,0                        | 3/6 ---10                      | 18/28                    | 13                    | 470         | -MF-G3010X |
|   | G 3/8"     | electric  | external     | 10     | 10               | -1,0 --- 6,0                        | 3/6 ---10                      | 18/28                    | 13                    | 455         | -MF-G3012X |
|   | G 1/2"     | electric  | external     | 15     | 20               | -1,0 --- 6,0                        | 3/6 ---10                      | 20/40                    | 13                    | 795         | -MF-G3021X |
|   | G 3/4"     | electric  | external     | 19     | 35               | -1,0 --- 6,0                        | 3/6 ---10                      | 20/40                    | 13                    | 765         | -MF-G3041X |
|   | G 1"       | electric  | external     | 25     | 90               | -1,0 --- 6,0                        | 3/6 ---10                      | 20/45                    | 13                    | 1150        | -MF-G3051X |
|   | G 1 1/2"   | electric  | external     | 39     | 180              | -1,0 --- 6,0                        | 3/6 ---10                      | 60/40                    | 13                    | 3340        | -MF-G3061X |
|   | G 2"       | electric  | external     | 50     | 250              | -1,0 --- 6,0                        | 3/6 ---10                      | 80/50                    | 13                    | 8690        | -MF-G3069X |
|  <p>3/2 NC Air/Spring</p>     | G 1/8"     | pneumatic | ---          | 5,5    | 1,5              | -1,0 --- 6,0                        | 3/6 ---10                      | 04/08                    |                       | 125         | -MF-G3071X |
|   | G 1/4"     | pneumatic | ---          | 8      | 4                | -1,0 --- 6,0                        | 3/6 ---10                      | 05/10                    |                       | 360         | -MF-G3073X |
|   | G 3/8"     | pneumatic | ---          | 10     | 10               | -1,0 --- 6,0                        | 3/6 ---10                      | 08/10                    |                       | 345         | -MF-G3075X |
|   | G 1/2"     | pneumatic | ---          | 15     | 20               | -1,0 --- 6,0                        | 3/6 ---10                      | 08/15                    |                       | 705         | -MF-G3081X |
|   | G 3/4"     | pneumatic | ---          | 19     | 35               | -1,0 --- 6,0                        | 3/6 ---10                      | 10/15                    |                       | 675         | -MF-G3091X |
|   | G 1"       | pneumatic | ---          | 25     | 90               | -1,0 --- 6,0                        | 3/6 ---10                      | 10/17                    |                       | 1060        | -MF-G3100X |
|   | G 1 1/2"   | pneumatic | ---          | 39     | 180              | -1,0 --- 6,0                        | 3/6 ---10                      | 65/30                    |                       | 3235        | -MF-G3110X |
|   | G 2"       | pneumatic | ---          | 50     | 250              | -1,0 --- 6,0                        | 3/6 ---10                      | 80/40                    |                       | 8585        | -MF-G3120X |
|  <p>3/2 NO Air/Spring</p>     | G 1/8"     | pneumatic | ---          | 5,5    | 1,5              | -1,0 --- 6,0                        | 3/6 ---10                      | 04/08                    |                       | 125         | -MF-G3072X |
|   | G 1/4"     | pneumatic | ---          | 8      | 4                | -1,0 --- 6,0                        | 3/6 ---10                      | 05/10                    |                       | 360         | -MF-G3074X |
|   | G 3/8"     | pneumatic | ---          | 10     | 10               | -1,0 --- 6,0                        | 3/6 ---10                      | 08/10                    |                       | 345         | -MF-G3076X |
|   | G 1/2"     | pneumatic | ---          | 15     | 20               | -1,0 --- 6,0                        | 3/6 ---10                      | 08/15                    |                       | 705         | -MF-G3082X |
|   | G 3/4"     | pneumatic | ---          | 19     | 35               | -1,0 --- 6,0                        | 3/6 ---10                      | 10/15                    |                       | 675         | -MF-G3092X |
|   | G 1"       | pneumatic | ---          | 25     | 90               | -1,0 --- 6,0                        | 3/6 ---10                      | 10/17                    |                       | 1060        | -MF-G3101X |
|   | G 1 1/2"   | pneumatic | ---          | 39     | 180              | -1,0 --- 6,0                        | 3/6 ---10                      | 65/30                    |                       | 3235        | -MF-G3111X |
|   | G 2"       | pneumatic | ---          | 50     | 250              | -1,0 --- 6,0                        | 3/6 ---10                      | 80/40                    |                       | 8585        | -MF-G3121X |

\* Control pressure from/to (bar) : 3,0 --- 10 ( Vacuum-Vacuum operation ) | 6,0 --- 10 ( Vacuum - Air operation )



## ACCESSORIES & SPARE PARTS

► Function 100% EDP ► Voltage ± 10% ► Frequency ± 5%

### COILS

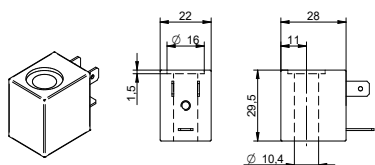

| Coil width (mm) | Operator Ø (mm) | Voltage | Power | Code      |
|-----------------|-----------------|---------|-------|-----------|
| 22              | 10              | 24 VDC  | 7 W   | -MF-0051X |
| 22              | 10              | 24 VAC  | 11 VA | -MF-0106X |
| 22              | 10              | 110 VAC | 10 VA | -MF-0108X |
| 22              | 10              | 220 VAC | 8 VA  | -MF-0124X |

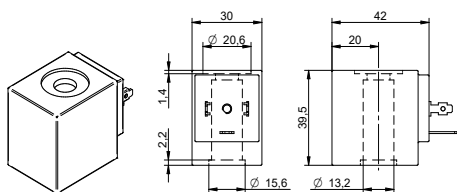

|    |    |         |       |           |
|----|----|---------|-------|-----------|
| 30 | 13 | 24 VDC  | 11 W  | -MF-0502X |
| 30 | 13 | 24 VAC  | 17 VA | -MF-0507X |
| 30 | 13 | 110 VAC | 15 VA | -MF-0509X |
| 30 | 13 | 220 VAC | 25 VA | -MF-0510X |

► IP65 ► PG9 / PG11

### CONNECTORS

#### DIN 43650-B

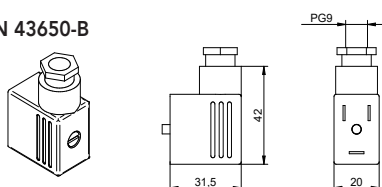

| Coil width (mm) | Voltage                  | Led-Vdr | Code      |
|-----------------|--------------------------|---------|-----------|
| 22              | 24V - 48V - 110 V- 220 V | -       | -AM-5110X |

#### DIN 43650-A

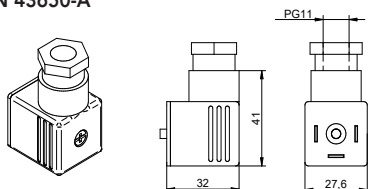

|    |                          |   |           |
|----|--------------------------|---|-----------|
| 30 | 24V - 48V - 110 V- 220 V | - | -AM-5111X |
|----|--------------------------|---|-----------|

### SERVICE KIT

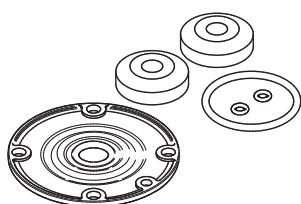

| Description  | Connection      | Code       |
|--|-----------------|------------|
| Buffers, lip seals, o-rings                              | G 1/8"          | -MF-F9605X |
| Buffers, lip seals, o-rings                              | G 1/4" - G 3/8" | -MF-F9610X |
| Membrane, pads, o-rings                                  | G 1/2" - G 3/4" | -MF-F9615X |
| Membrane, pads, o-rings                                  | G 1"            | -MF-F9620X |
| Membrane, pads, o-rings, quick-discharge membrane        | G 1 1/2"        | -MF-F9625X |
| Buffers, lip seals, o-rings, quick exhaust membrane G 2" | G 2"            | -MF-F9630X |



## MF-HyDrive™ ATEX

ALL DATA SHEET AVAILABLE:  
[MECFLUID2.COM](http://MECFLUID2.COM)

SCAN THIS QR CODE



# MF-HyDrive™ BISTABLE

3 / 2 POPPET VALVES

**VACUUM -AIR**

**BISTABLE**

- Range G 1/4" ÷ G1"
- With **bistable solenoid pilot**; the valve requires an electrical signal to change the position of the shutter
- Patented conical poppet system and shaped PU membrane
- Equipped with low-consumption coil and connector
- Control pressure: 3-10 bar in direct vacuum operations; 6-10 bar in air-vacuum operations



## TECHNICAL FEATURES

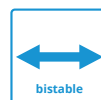

|                          |   |        |        |        |      |
|--------------------------|---|--------|--------|--------|------|
| Fluid                    | Filtered compressed air, with or without lubrication - vacuum                                   |        |        |        |      |
| Ambient Temp.            | -10 ÷ +50°C   |        |        |        |      |
| Fluid Temp.              | Max 755 mmHg  |        |        |        |      |
| Function                 | BISTABLE  |        |        |        |      |
| Control                  | Indirect electric   |        |        |        |      |
| Return                   | Mechanical and pneumatic spring   |        |        |        |      |
| Connection               | G 1/4"  | G 3/8" | G 1/2" | G 3/4" | G 1" |
| Shape                    |   |        |        |        |      |
| Ø electric operator (mm) | 15X15   |        |        |        |      |
| Absorption               | 2,5W  |        |        |        |      |
| Voltage                  | 24VDC   |        |        |        |      |
| Mounting position        | Preferably vertical   |        |        |        |      |
| Materials                | Body: aluminum / Seals: PU - NBR / Internal parts: aluminum - POM - Brass / Caps: polyamide PA6 |        |        |        |      |

## PRODUCT DATA & CODES

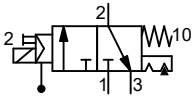
|   | Connection | Control           | Pilot supply | Ø (mm) | Flow rate (mq/h) | Working pressure (P1) from/to (bar) | Control pressure from/to (bar) | Time Exc. 12/ Dis.10 (ms) | Weight | Code           |
|---|------------|-------------------|--------------|--------|------------------|-------------------------------------|--------------------------------|---------------------------|--------|----------------|
|  | G 1/4"     | bistable electric | external     | 8      | 4                | 3---10                              | 3/6 ---10                      | 44/48                     | 360    | -MF-G3009SF02B |
|   | G 3/8"     | bistable electric | external     | 10     | 10               | 3---10                              | 3/6 ---10                      | 45/50                     | 345    | -MF-G3011SF02B |
|   | G 1/2"     | bistable electric | external     | 15     | 20               | 3---10                              | 3/6 ---10                      | 48/50                     | 620    | -MF-G3020SF02B |
|   | G 3/4"     | bistable electric | external     | 19     | 35               | 3---10                              | 3/6 ---10                      | 48/55                     | 590    | -MF-G3040SF02B |
|   | G 1"       | bistable electric | external     | 25     | 90               | 3---10                              | 3/6 ---10                      | 50/55                     | 940    | -MF-G3050SF02B |

\* Control pressure from/to (bar) : 3,0 --- 10 ( Vacuum-Vacuum operation) | 6,0 --- 10 (Vacuum - Air operation)

## ACCESSORIES & SPARE PARTS

### CONNECTORS

► IP65 ► PG7

DIN 43650-C

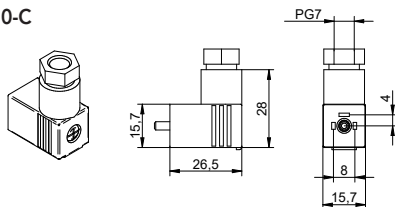

Voltage

Led-Vdr

Code

24V - 48V - 110 V- 220 V

-

-AM-5109C

### SERVICE KIT

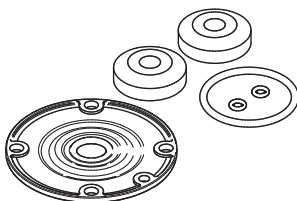

Description

Connection

Code

Buffers, lip seals, o-rings

G 1/4" - G 3/8"

-MF-F9610

Membrane, buffers, o-rings

G 1/2" - G 3/4"

-MF-F9615

Membrane, buffers, o-rings

G 1"

-MF-F9620