

PRODUCT RANGE OVERVIEW

- MF-VacDrive™ : ALUMINIUM CAPS SERIES
- MF-VacDrive™ SMART: POLYARILAMIDE CAPS SERIES
- MF-VacDrive™ ATEX ATEX CERTIFIED SERIES
- MF-VacDrive™ BISTABLE : BISTABLE PILOT SERIES

ENGINEERED DESIGN

Body: aluminum

Seals: PU - NBR - Silicon Viton

Internal parts: aluminum - POM

Caps: 2011 aluminum - black anodized. Polyamide PA6. /polyarylamide IXEF AG (for SMART series)

KEY FEATURES

Vacuum–vacuum operation: specifically engineered for applications where vacuum must be managed on both circuits with maximum safety and reliability.

Secure sealing and fast response: the poppet valve system ensures tight sealing, quick switching, and stable performance even under critical operating conditions.

Compact and lightweight design: easy to install in any vacuum line, ideal for space-constrained systems.

Durable construction: high-resistance sealing materials ensure long service life and reliable operation over time.

Versatile integration: available in different sizes and mounting options for easy integration into fully vacuum-based automation systems.

AVAILABLE SIZES

	1/8"	1/4"	3/8"	1/2"	3/4"	1"	1 1/2"	2"
Nominal diameter	8	10	15	19	19	25	39	50
Vacuum flow rate at 755 mm HG	4	10	20	35	35	90	180	250

MF-VacDrive™

3/2 POPPET VALVES DIRECT VACUUM

- Range G1/4" ÷ G1-1/2"
- Patented conical shutter system and shaped PU membrane
Version with internal actuation, does not require compressed air
- Robust construction and low weight

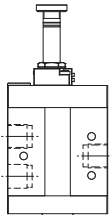
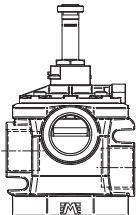

TECHNICAL FEATURES

Fluid	Vacuum						
Ambient Temp.	-20 ÷ +50°C						
Fluid Temp.	Max +50°C						
Max vacuum	150 / 755 mmHg						
Function	3/2 NC 3/2 NO						
Control	Indirect electric						
Return	Vacuum						
Manual control	Screw, 2 positions						
Connection	G 1/4"	G 3/8"	G 1/2"	G 3/4"	G 1"	G 1 1/2"	
Shape							
Ø electric operator (mm)	13						
Absorption	11W (DC) – 10VA (AC)						
Voltage	12V DC – 24V DC – 24V AC – 110V AC – 220 AC						
Mounting position	Vertical only						
Materials	Body: aluminum / Seals: PU - NBR / Internal parts: aluminum - POM - Brass - Nickel Plated						

PRODUCT DATA & CODES

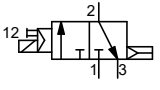
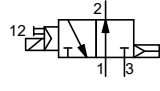
	Connection	Control	Pilot Supply	Ø (mm)	Flow rate (mq/h)	Time. Exc. 12/ Dis.10 (ms)	Electric Pilot Ø (mm)	Weight	Code
 <p>3/2 NC Solenoid/Vacuum</p>	G 1/4"	electric	internal	8	4	25/18	13	470	-MF-G3210
	G 3/8"	electric	internal	10	10	25/18	13	455	-MF-G3214
	G 1/2"	electric	internal	15	20	30/18	13	800	-MF-G3222
	G 3/4"	electric	internal	19	35	30/18	13	760	-MF-G3232
	G 1"	electric	internal	25	90	40/20	13	1220	-MF-G3242
 <p>3/2 NO Solenoid/ Vacuum</p>	G 1 1/2"	electric	internal	39	100	75/50	13	3300	-MF-G3256
	G 1/4"	electric	internal	8	4	20/15	13	470	-MF-G3211
	G 3/8"	electric	internal	10	10	20/15	13	455	-MF-G3215
	G 1/2"	electric	internal	15	20	20/20	13	800	-MF-G3223
	G 3/4"	electric	internal	19	35	20/20	13	760	-MF-G3233
	G 1"	electric	internal	25	90	25/20	13	1220	-MF-G3243
	G 1 1/2"	electric	internal	39	100	70/60	13	3300	-MF-G3257

ACCESSORIES & SPARE PARTS

> Function 100% EDP > Voltage ± 10% > Frequency ± 5%

COILS

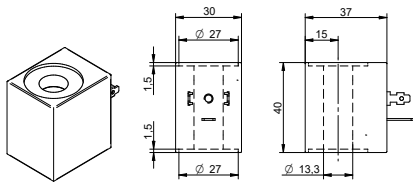

Coil width (mm)	Operator Ø (mm)	Voltage	Power	Code
30	13	12 VDC	11 W	-MF-0501
30	13	24 VDC	11 W	-MF-0502
30	13	24 VAC	10 VA	-MF-0507
30	13	110 VAC	10 VA	-MF-0509
30	13	220 VAC	10 VA	-MF-0510

CONNECTORS

> IP65 > PG69

DIN 43650-A

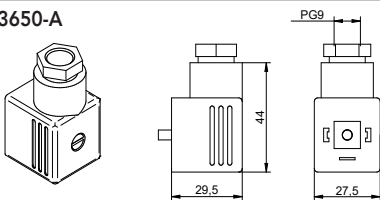

Coil width (mm)	Voltage	Led-Vdr	Code
30	24V - 48V - 110 V- 220 V	-	-AM-5111
30	24 volt	✓	-AM-5115L
30	110 volt	✓	-AM-5116L
30	220 volt	✓	-AM-5117L

SERVICE KIT

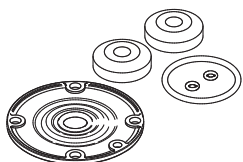

Description	Connection	Code
Buffers, lip seals, o-rings	G1/4" - G3/8"	-MF-G9635
Membrane, buffers, o-rings	G1/2" - G3/4"	-MF-G9640
Membrane, buffers, o-rings	G1"	-MF-G9645



MF-VacDrive™ SMART

3/2 POPPET VALVES

DIRECT VACUUM

SMART

- Range G1/4" ÷ G1-1/2"
- Patented conical shutter system and shaped PU membrane
Version with internal actuation, does not require compressed air
- Robust construction and low weight



TECHNICAL FEATURES

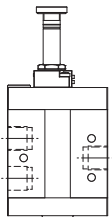
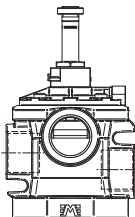

Fluid	Vacuum						
Ambient Temp.	-20 ÷ +50°C						
Fluid Temp.	Max +50°C						
Max vacuum	150 / 755 mmHg						
Function	3/2 NC 3/2 NO						
Control	Indirect electric						
Return	Vacuum						
Manual control	Screw, 2 positions						
Connection	G 1/4"	G 3/8"	G 1/2"	G 3/4"	G 1"	G 1 1/2"	
Shape							
Ø electric operator (mm)	13						
Absorption	11W (DC) – 10VA (AC)						
Voltage	12V DC – 24V DC – 24V AC – 110V AC – 220 AC						
Mounting position	Vertical only						
Materials	Body: aluminum / Seals: PU - NBR / Internal parts: aluminum - POM - Brass - Nickel Plated Caps: sizes from G 1/8" to G 3/8" standard in polyamide PA6. Sizes G 1/2" G 3/4", G 1" in polyarylamide IXEF AG						

PRODUCT DATA & CODES

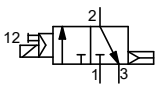
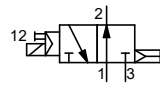
	Connection	Control	Pilot Supply	Ø (mm)	Flow rate (mq/h)	Time. Exc. 12/ Dis.10 (ms)	Electric Pilot Ø (mm)	Weight	Code
 3/2 NC Solenoid/Vacuum	G 1/4"	electric	internal	8	4	25/18	13	410	-MF-G3210S
	G 3/8"	electric	internal	10	10	25/18	13	395	-MF-G3214S
	G 1/2"	electric	internal	15	20	30/18	13	675	-MF-G3222S
	G 3/4"	electric	internal	19	35	30/18	13	635	-MF-G3232S
	G 1"	electric	internal	25	90	40/20	13	1050	-MF-G3242S
 3/2 NO Solenoid/Vacuum	G 1/4"	electric	internal	8	4	20/15	13	410	-MF-G3211S
	G 3/8"	electric	internal	10	10	20/15	13	395	-MF-G3215S
	G 1/2"	electric	internal	15	20	20/20	13	675	-MF-G3223S
	G 3/4"	electric	internal	19	35	20/20	13	635	-MF-G3233S
	G 1"	electric	internal	25	90	25/20	13	1050	-MF-G3243S

ACCESSORIES & SPARE PARTS

► Function 100% EDP ► Voltage ± 10% ► Frequency ± 5%

COILS

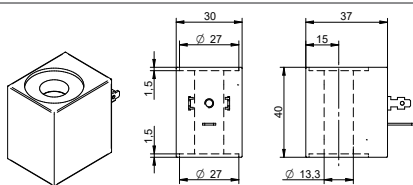

Coil width (mm)	Operator Ø (mm)	Voltage	Power	Code
30	13	12 VDC	11 W	-MF-0501
30	13	24 VDC	11 W	-MF-0502
30	13	24 VAC	10 VA	-MF-0507
30	13	110 VAC	10 VA	-MF-0509
30	13	220 VAC	10 VA	-MF-0510

CONNECTORS

► IP65 ► PG9

DIN 43650-A

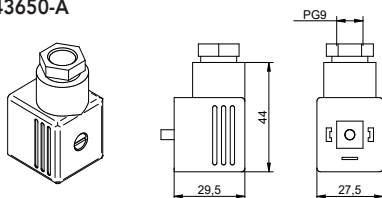

Coil width (mm)	Voltage	Led-Vdr	Code
30	24V - 48V - 110 V - 220 V	-	-AM-5111
30	24 volt	✓	-AM-5115L
30	110 volt	✓	-AM-5116L
30	220 volt	✓	-AM-5117L

SERVICE KIT

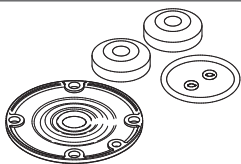

Description	Connection	Code
Buffers, lip seals, o-rings	G1/4" - G3/8"	-MF-G9635
Membrane, buffers, o-rings	G1/2" - G3/4"	-MF-G9640
Membrane, buffers, o-rings	G1"	-MF-G9645

MF-VacDrive™ ATEX

3/2 POPPET VALVES DIRECT VACUUM ATEX CERTIFIED

- Range G 1/8" + G 2"
- Body and caps in aluminium
- Also available with external pilot control

Conformity with EU Directive 2014/34 **CE** **Ex**
ELECTRIC CONTROL II 3G Ex h IIC T3 Gg
 II 3D Ex h IIIC T200°C Dc
PNEUMATIC CONTROL II 3G Ex h IIC T6 Gg
 II 3D Ex h IIIC T85°C Dc



TECHNICAL FEATURES



Fluid	Vacuum						
Ambient Temp.	-20 ÷ +50°C						
Fluid Temp.	Max +50°C						
Max vacuum	150 / 755 mmHg						
Function	3/2 NC 3/2 NO						
Control	Indirect electric						
Return	Vacuum						
Manual control	Screw, 2 positions						
Connection	G 1/4"	G 3/8"	G 1/2"	G 3/4"	G 1"	G 1 1/2"	
Shape							
Ø electric operator (mm)	13						
Absorption	11W(DC)-15VA(AC)-17VA(AC)-25VA(AC)						
Voltage	24VDC- 24VAC-110VAC-220VAC						
Mounting position	Vertical only						
Materials	Body: aluminum / Seals: PU - NBR / Internal parts: aluminum - POM - Brass - Nickel Plated Caps: 2011 alloy aluminum - black anodized.						

PRODUCT DATA & CODES

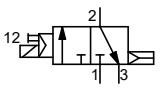
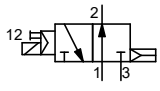
	Connection	Control	Pilot Supply	Ø (mm)	Flow rate (mq/h)	Time. Exc. 12/ Dis.10 (ms)	Electric Pilot Ø (mm)	Weight	Code
 3/2 NC Solenoid/Vacuum	G 1/4"	electric	internal	8	4	25/18	13	460	-MF-G3210X
	G 3/8"	electric	internal	10	10	25/18	13	445	-MF-G3214X
	G 1/2"	electric	internal	15	20	30/18	13	790	-MF-G3222X
	G 3/4"	electric	internal	19	35	30/18	13	750	-MF-G3232X
	G 1"	electric	internal	25	90	40/20	13	1210	-MF-G3242X
	G 1 1/2"	electric	internal	39	100	75/50	13	3290	-MF-G3256X
 3/2 NO Solenoid/Vacuum	G 1/4"	electric	internal	8	4	20/15	13	460	-MF-G3211X
	G 3/8"	electric	internal	10	10	20/15	13	445	-MF-G3215X
	G 1/2"	electric	internal	15	20	20/20	13	790	-MF-G3223X
	G 3/4"	electric	internal	19	35	20/20	13	750	-MF-G3233X
	G 1"	electric	internal	25	90	25/20	13	1210	-MF-G3243X
	G 1 1/2"	electric	internal	39	100	70/60	13	3290	-MF-G3257X

ACCESSORIES & SPARE PARTS

► Function 100% EDP ► Voltage ± 10% ► Frequency ± 5%

COILS

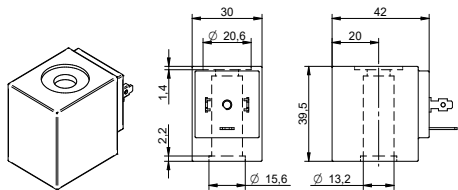

Coil width (mm)	Operator Ø (mm)	Voltage	Power	Code
30	13	24 VDC	11 W	-MF-0502X
30	13	24 VAC	17 VA	-MF-0507X
30	13	110 VAC	15 VA	-MF-0509X
30	13	220 VAC	25 VA	-MF-0510X

CONNECTORS

► IP65 ► PG11

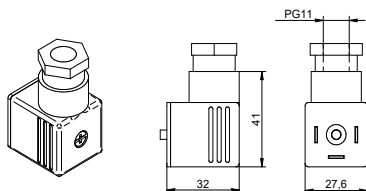

Coil width (mm)	Voltage	Led-Vdr	Code
30	24V - 48V - 110 V- 220 V	-	-AM-5111X

SERVICE KIT

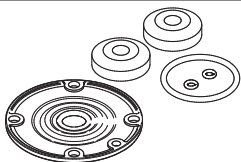

Description	Connection	Code
Buffers, lip seals, o-rings	G1/4" - G3/8"	-MF-G9635
Membrane, buffers, o-rings	G1/2" - G3/4"	-MF-G9640
Membrane, buffers, o-rings	G1"	-MF-G9645
Membrane, buffers, o-rings, quick-discharge membrane	G1 1/2"	-MF-G9650

MF-VacDrive™ BISTABLE

3 / 2 POPPET VALVES

DIRECT VACUUM

BISTABLE

- Range G1/4" ÷ G1"
- Air and Vacuum Version (with external compressed air or self- powered servo-control)
- With bistable solenoid pilot; the valve requires an electrical signal to change the position of the shutter
- Patented conical shutter system and shaped PU membrane
- Robust construction and low weight
- Equipped with low-consumption coil and connector



TECHNICAL FEATURES



Fluid	Vacuum				
Ambient Temp.	-10 ÷ +50°C				
Max Vacuum	150 / 755 mmHg				
Function	3/2 NC 3/2 NO				
Control	Indirect electric				
Return	Vacuum				
Connection	G 1/4"	G 3/8"	G 1/2"	G 3/4"	G 1"
Shape					
Ø electric operator (mm)	15x15				
Absorption					
Voltage	24VDC				
Mounting position	Only vertical				
Materials	Body: aluminum / Seals: PU - NBR / Internal parts: aluminum - POM / Caps: polyamide PA6				

PRODUCT DATA & CODES

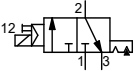
	Connection	Control	Pilot Supply	Ø (mm)	Flow rate (mq / h)	Max vacuum (mm / Hg)	Time Exc. 12/ Dis.10 (ms)	Weight (gr)	Code
	G 1/4"	bistable electric	internal	8	4	755	65/58	410	-MF-G3210SF02B
	G 3/8"	bistable electric	internal	10	10	755	65/58	395	-MF-G3214SF02B
	G 1/2"	bistable electric	internal	15	20	755	70/58	675	-MF-G3222SF02B
	G 3/4"	bistable electric	internal	19	35	755	70/58	635	-MF-G3232SF02B
	G 1"	bistable electric	internal	25	90	755	80/60	1050	-MF-G3242SF02B

ACCESSORIES & SPARE PARTS

► IP65 ► PG7

CONNECTORS

DIN 43650-C

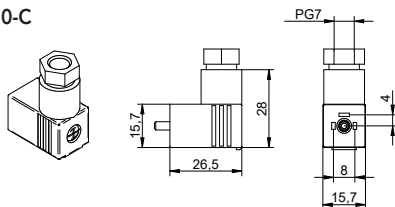

Voltage

Led-Vdr

Code

24V - 48V - 110 V- 220 V

-

-AM-5109C

SERVICE KIT

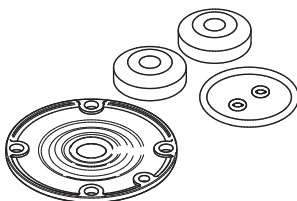

Description

Connection

Code

Buffers, lip seals, o-rings

G1/4" - G3/8"

-MF-G9635

Membrane, buffers, o-rings

G1/2" - G3/4"

-MF-G9640

Membrane, buffers, o-rings

G1"

-MF-G9645